

# SSR, SSI SERIES



## Vacuum Receivers

### ACCOMMODATE FUTURE PRODUCTION REQUIREMENTS

SSR Series vacuum receivers from Sterling feature modular stainless steel design, offering significant operational advantages. The modular design allows these units to be economically reconfigured to accommodate future production requirements. Pyrex™ sight glass on SSI models allow for easy visual monitoring of material flow.

SSR/SSI Series vacuum receivers are used at each loading point in a central vacuum conveying system. **SSI/SSR01, 03 and SSR06 receivers are not to be used on single line Y systems and SSR/SSI 11 receivers are not recommended. These small receivers should be used from beside the machine or with dedicated line systems.**



#### Features

- Brushed stainless steel construction
- Material demand/level sensor
- Internal check valve on material inlet for 1.5", 2.0", 2.5" and 3.0" (not available on 0.03, 0.1, or 0.2 cu. ft. models)
- Removable **aluminum** inlets and outlets on most models  
SSR03 - stainless steel non-removable  
SSR06-11 - removable aluminum (1.5-2.5" O.D.)  
SSR23-45 - removable aluminum (1.5-3.5" O.D.)  
SSR85-170 - removable aluminum (2.0-4.0" O.D.)  
SSR85-170 - stainless steel welded, non-removable (4.5-5" O.D. sch. 10)
- SSR receivers include counter-weighted, angle discharge throat with throat gasket seal (SSR03 - 1.5" throat, SSR06-45 - 4" throat, SSR85-170 - 6" throat)
- Stainless steel filter screen (10 mesh) (0.03–1.6 cu. ft. models), stainless steel pellet deflector (3.0–6.0 cu. ft. models)
- Vacuum outlet on side cover (SSR03 and SSR06-45 models)
- Vacuum outlet on top of cover - straight outlet (SSR85-170 models). Note - optional outlets available for SSR85-170
- Sight glass models feature Pyrex™ sight glass, 10-mesh stainless steel screen, and square flange. SSI11 includes check valve for single-line Y applications.

#### Options

- Volume-fill sensor, 180°F maximum, 24 VDC or 115 VAC control voltage (not available on 0.03–0.1 cu. ft. models)
- Stainless steel 20 mesh screen for micro-pellet applications
- Polyester cloth filter in lieu of standard screen/deflector
- Nylon filter in lieu of standard screen/deflector (150 mesh)
- OptiView riser assembly, flange mount, 150°F ambient max. temp. (not available on SSR85-170)
- Machine-mount adapter for OptiView (or aluminum riser), square mounting flange (not available on SSR85-170)
- Aluminum riser, flange-mount only (not available on SSR03 or SSI models)
- Silo-mount riser with gasketed, non-vented access door, part no. A0566986 (SSR85-170 only)
- Aluminum riser with vented access door, part no. A0566987 (SSR85-170 only)
- High-temperature (400°F) silicone discharge throat gasket (not available on 0.03–0.1 cu. ft. models)
- White neoprene discharge throat gasket, FDA approved, 180°F max. (not available on 0.03–0.1 cu. ft. models)
- 90° vacuum outlets (SSR85-170 only)
- Adapter to fit TF/VF mounting hole, (18" dia. to 15" dia. BC, part. no. A0569579 (SSR85-170 only)
- 70° cone for hard to flow materials in lieu of standard (special order only)
- Vibrating pads for 70° cone section (special order only)
- 253mm O.D. mounting flange (no bolt pattern) for SSR06-45 in lieu of standard flange part no. 822.00616.00

# SSR, SSI SERIES

## Vacuum Receivers

### SPECIFICATIONS

Model	Receiver Capacity cu. ft. (l)	Receiver Capacity lbs. (Kg)	Shipping Weight lbs. (Kg)	Standard inlet/outlet sizes	Sight Glass Capacity cu. ft. (l)	
SSR03	0.1 (2.8)	3 (1.5)	29 (13)	1.5 (38)	N/A	N/A
SSR06	0.2 (5.6)	6.0 (3.1)	31 (14)	1.5, 2 (38, 51)	N/A	N/A
SSR11	0.4 (11.3)	12.0 (6.3)	33 (15)	1.5, 2, 2.5 <sup>1</sup> (38, 51, 64 <sup>1</sup> )	N/A	N/A
SSR23	0.8 (22)	25 (12.7)	40 (18)	2, 2.5, 3 (51, 64, 76)	N/A	N/A
SSR45	1.6 (45)	50 (25.4)	43 (20)	2, 2.5, 3, 3.5 <sup>2</sup> (51, 64, 76, 89 <sup>2</sup> )	N/A	N/A
SSR85	3.0 (85)	100 (45)	75 (34)	2.5, 3, 3.5, 4, 4.5 (64, 76, 89, 101, 114)	N/A	N/A
SSR170	6.0 (170)	200 (90)	95 (43)	2.5, 3, 3.5, 4, 4.5, 5 sch. 10 (64, 76, 89, 101, 114, 143)	N/A	N/A

- 1) Includes 2.5" to 2" transition on inlet/outlet and 2" check valve on inlet  
 2) Includes 3.5" to 3" transition on inlet/outlet and 3" check valve on inlet

Model	Receiver Capacity cu. ft. (l)	Receiver Capacity lbs. (Kg)	Shipping Weight lbs. (Kg)	Standard inlet/outlet sizes	Sight Glass Capacity cu. ft. (l)	
SSI01	0.028 (0.79)	1 (0.45)	15 (7)	1.5 (38)	0.01 (0.28)	0.34 (0.15)
SSI03	0.1 (2.8)	3.0 (1.5)	27 (13)	1.5 (38)	0.02 (0.57)	0.68 (0.31)
SSI06	0.2 (5.6)	6.0 (3.1)	47 (22)	1.5, 2 (38, 51)	0.09 (2.55)	3.25 (1.48)
SSI11	0.4 (11.3)	12.0 (6.3)	49 (23)	1.5, 2, 2.5 <sup>1</sup> (38, 51, 64 <sup>1</sup> )	0.09 (2.55)	3.25 (1.48)

### Optional Remote Proportioning Package

- Includes proportioning valve, 2 aluminum pick-up wands, 2x10' vinyl flex hoses, 4 hose clamps, and controller assembly
- 1.5", 2", 2.5" OD inlet/outlet
- Hopper, floor stand, or wall mounting
- 115/1/60, 230/1/60, or 24 VDC supply voltage
- 115/1/60 or 24 VDC control voltage
- For 1.75" and 2.25" OD uses, use aluminum transitions/couplers (quote separately)



SSR Vacuum Receiver



SSI Vacuum Receiver



SPV Remote Proportioning Valve



# SSR, SSI SERIES



Vacuum Receivers

## DIMENSIONS

SSR Dimensions, in. (cm)									
Model	A	B	C	D	E	F	G	H <sup>1</sup>	J <sup>2</sup>
SSR03	14.875 (38)	10.625 (27)	9.375 (24)	6.38 (16)	12 (31)	1.75 (4)	6.375 (16)	5.5 (14)	11 (28)
SSR06	16.75 (43)	11.5 (29)	9.50 (24)	5.5 (14)	12 (31)	4 (10)	9.125 (23)	N/A	11 (28)
SSR11	22.375 (57)	17.5 (45)	13.50 (34)	11.5 (29)	12 (31)	4 (10)	9.125 (23)	N/A	11 (28)
SSR23	26 (66)	20.125 (51)	17.625 (45)	11.625 (30)	12 (31)	4 (10)	14.125 (36)	N/A	11 (28)
SSR45	32.25 (82)	26.375 (67)	23.875 (61)	18.125 (46)	12 (31)	4 (10)	14.125 (36)	N/A	11 (28)
SSR85	46.56 (119)	39.21 (100)	N/A	25.75 (66)	16 (41)	6 (15)	20 (51)	N/A	15 (38)
SSR170	62.56 (159)	55.21 (140)	N/A	41.75 (106)	16 (41)	6 (15)	20 (51)	N/A	15 (38)

- 1) .312" (8 mm) dia. holes; 2 places, equally spaced
- 2) .312" (8 mm) dia. holes; 12 places equally spaced

### General Notes:

0.03, 0.1, 0.2, 0.4, 0.8 and 1.6 cu. ft. models have vacuum outlet mounted on the side of the cover.  
 3.0 and 6.0 cu. ft. models have the vacuum outlet at the top of the cover.

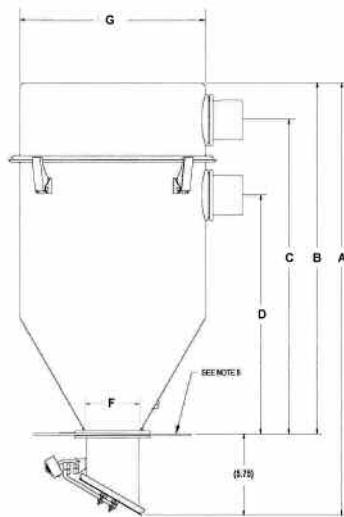

SSR45 Vacuum Receiver

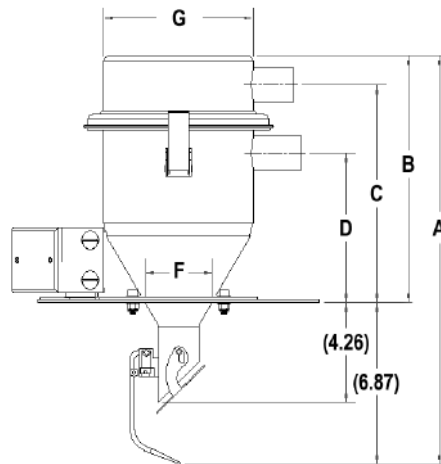

SSR03 Vacuum Receiver

### Mounting Pattern - Flange Mount Configuration

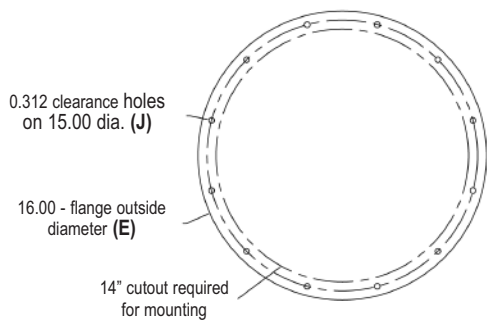

SSR85/170

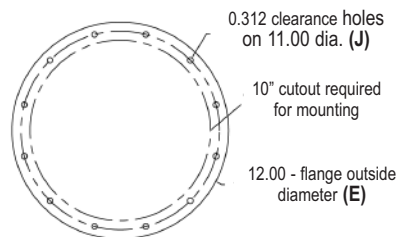

SSR03/45

# SSR, SSI SERIES

Vacuum Receivers

## SSR 85/170 VACUUM RECEIVER WITH RISER MOUNT OPTION

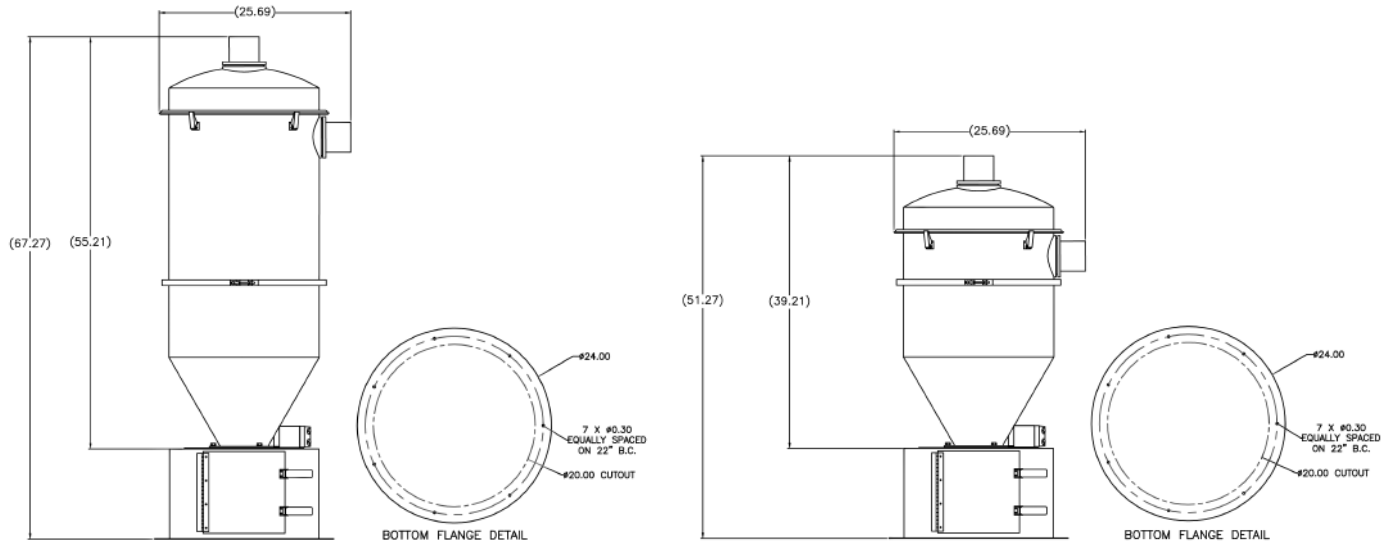

## DIMENSIONS

SSI Dimensions, in. (cm)										
Model	A	B	C	D	E	F	G	H	I <sup>3</sup>	J
SSI01	17.50 (44)	16.125 (42)	12.50 (32)	6.375 (16)	1.75 (4)	4 (10)	2 (5)	1.25 (3)	2.5 (6)	2 (5)
SSI03	21.25 (54)	20 (51)	16.625 (42)	6.375 (16)	1.75 (4)	4 (10)	2 (5)	1.25 (3)	2.5 (6)	2 (5)
SSI06	25.625 (65)	23.75 (60)	19.5 (50)	9.125 (23)	3 (8)	7 (18)	3.5 (9)	2.75 (7)	5.5 (14)	3 (8)
SSI11 <sup>1</sup>	31.5 (80)	29.625 (75)	25.5 (65)	9.125 (23)	3 (8)	7 (18)	3.5 (9)	2.75 (7)	5.5 (14)	3 (8)

<sup>1</sup> Model now shown

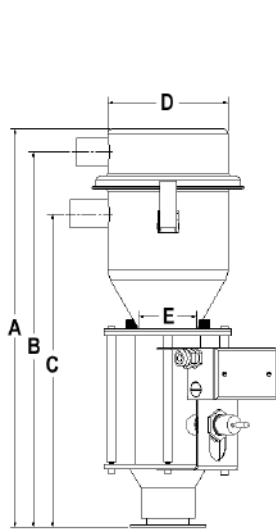

SSI03 Vacuum Receiver

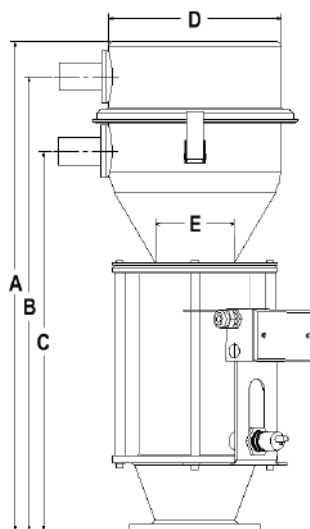

SSI06 Vacuum Receiver

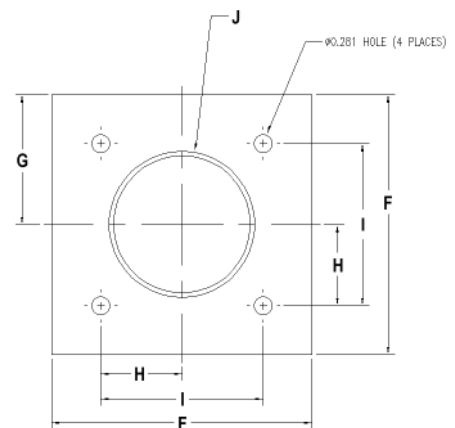

SSI Mounting Flange